

THIS TEST COMES WITH:



COLLECTION DO'S & DON'TS

- ✓ **DO** — Collect sample by scraping the complete wound surface with a scalpel or curette. Optional method is to swab the entire wound area.
- ✓ **DO** — Use Lidocaine if required but remove all Lidocaine prior to sampling by cleansing with saline.
- ✓ **DO** — Use injectable Lidocaine, as long as it does not get on the sample material.
- ✓ **DO** — Remove slough and non viable material prior to taking your sample from the host tissue.
- ✓ **DO** — Ship your sample as soon as possible after collection. This is optimal, however, if there is a slight delay, MicroGenDX samples are stable significantly longer than culture samples.
- ✗ **DO NOT** — Get biocides, cleaning agents, or lidocaine on the tissue or swab sample. They will degrade the DNA during transport to the lab.
- ✗ **DO NOT** — Do intensive deep debridement prior to taking the sample. The sample taken could contain only HOST DNA and you will receive an inconclusive result.
- ✗ **DO NOT** — Use topical antibiotics or antifungals 24 hours prior to collection.
- ✗ **DO NOT** — Use Biofilm disrupting products. These agents may contain substances, like DNase, that can destroy bacterial DNA and inhibit your results. Consider instructing patients to pause the use of Biofilm disruptors for 24-48hrs prior to sample collection.

SWAB COLLECTION METHOD

STEP 1
Use gauze and saline to lightly wipe the surface area to remove slough.

STEP 2
Open the swab ensuring hands do not touch the stem.

STEP 3
Roll the swab over entire surface area of the wound applying pressure as it moves across the wound. Get as much material on the swab as possible to ensure a conclusive sample.

STEP 4
Insert swab back into specimen tube and seal tightly.



DEBRIDEMENT COLLECTION METHOD

STEP 1
Use gauze and saline to lightly wipe the surface area to remove slough.

STEP 2
For patient comfort, administer numbing agent when necessary. Wipe off all lidocaine gel with saline prior to taking sample.

STEP 3
Scrape down debris until there is a little bit of bleeding. Collect samples from all areas of the wound when possible to ensure a full and accurate sample.

STEP 4
Transfer sample from tools into 2mL specimen vial, making sure hands don't make contact with the sample or rim of the vial. Include all debridement material in your sample by placing into 2mL vial or the swab tube.



SEE PATIENT INFORMATION & SHIPPING INSTRUCTIONS ON REVERSE



Correct packaging is vital to ensuring your sample is processed in a timely manner. Please follow the steps below.

PATIENT INFORMATION

1. MARK SAMPLE

Use a permanent marker to write patient name, date of birth and sample collection date on the Dry Swab Tube or 2mL Vial.



2. SIGN LAB REQ

Please have the patient sign the lab requisition form accepting financial responsibility. Be sure the physician has also signed the lab requisition form confirming consent.



3. INSURANCE INFORMATION

Submit patient face sheet and demographics with insurance information or both sides of a patient's insurance card. If this is a prepaid test skip this step.



PACKING SAMPLES FOR SHIPMENT

1. Slide the folded Lab Requisition Form into the open back pocket of the Biohazard Bag.
2. Place the Dry Swab or 2mL Vial into the center sealable pocket of Biohazard Bag.
3. **IMPORTANT:** Place only one Sample and one lab requisition in each Biohazard Bag.
4. Securely seal the Biohazard Bag making sure it is completely closed.
5. Place the sealed Biohazard Bag into the MicroGenDX Shipping Box (**shipping label already attached to bottom of box*).
6. Close the MicroGenDX Shipping Box and seal with the clear sealing sticker or a piece of tape.
7. **You can add multiple completed lab bags into the MicroGenDX Shipping Box.**

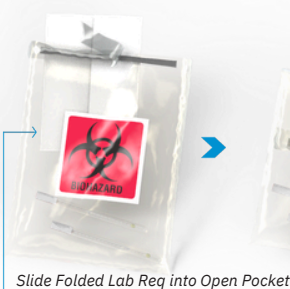

3 CONVENIENT FEDEX SHIPPING METHODS

1. Drop into FedEx Dropbox including FedEx locations.
2. For Physician Offices Only: Call for pick up 1-800-GoFedEx (1-800-463-3339). Say "agent" twice to speak to agent. Let them know it's prepaid pick up.
3. For Physician Offices Only: Use our online "Schedule a Pickup" page at www.MicroGenDX.com. **Make sure to retain your tracking number.**

