

### THIS TEST COMES WITH:



### COLLECTION DO'S & DON'TS

- ✓ **DO** — Clean the genital area with soap and water before collecting the sample.
- ✓ **DO** — Ship your sample as soon as possible after collection. This is optimal, however, if there is a slight delay, MicroGenDX samples are stable significantly longer than culture samples.
- ✗ **DO NOT** — Use a condom to collect the semen.
- ✗ **DO NOT** — Let the specimen come into contact with anything other than the collection cup. Including hands or any other body part.
- ✗ **DO NOT** — Use Biofilm disrupting products. These agents may contain substances, like DNase, that can destroy bacterial DNA and inhibit your results. Consider instructing patients to pause the use of Biofilm disruptors for 24-48hrs prior to sample collection.



Scan to Watch the SEMEN  
Sample Collection Video

### SEMEN SAMPLE COLLECTION

#### STEP 1

Use the included Cleansing Wipe to clean the genital area.



#### STEP 2

Collect semen excretion into sterile container. If enough excretion is collected (*more than a pea size amount*), cap and seal the container and prepare for shipping. If you have only collected a minimal amount, proceed to step 3.



#### STEP 3 **\*\*Do this step only if necessary\*\***

If only a minimal amount of semen excretion is collected (*pea size amount*) use the swab to collect the fluid by rolling swab through the fluid in the collection cup collecting as much fluid as possible on the swab tip.



#### STEP 4

Insert the swab back into the specimen tube and push until securely closed.



SEE PATIENT INFORMATION &  
SHIPPING INSTRUCTIONS ON REVERSE

## PATIENT INFORMATION

### 1. MARK SAMPLE

Use a permanent marker to write patient name, date of birth and sample collection date on the 90mL Cup or Multi-Purpose Swab Specimen Tube.



### 2. SIGN LAB REQ

Please have the patient sign the lab requisition form accepting financial responsibility. Be sure the physician has also signed the lab requisition form confirming consent.



### 3. INSURANCE INFORMATION

Submit patient face sheet and demographics with insurance information or both sides of a patient's insurance card. If this is a prepaid test skip this step.



## PACKING SAMPLES FOR SHIPMENT

1. Slide the folded Lab Requisition Form into the open back pocket of the Biohazard Bag.
2. Place the 90mL Collection Cup or Multi-Purpose Swab into the center sealable pocket of Biohazard Bag.
3. **IMPORTANT:** Place only one Sample and one lab requisition in each Biohazard Bag.
4. Securely seal the Biohazard Bag making sure it is completely closed.
5. Place the sealed Biohazard Bag into the MicroGenDX Shipping Box (*\*shipping label already attached to bottom of box*).
6. Close the MicroGenDX Shipping Box and seal with the clear sealing sticker or a piece of tape.
7. You can add multiple completed Biohazard Bags into the MicroGenDX Shipping Box.

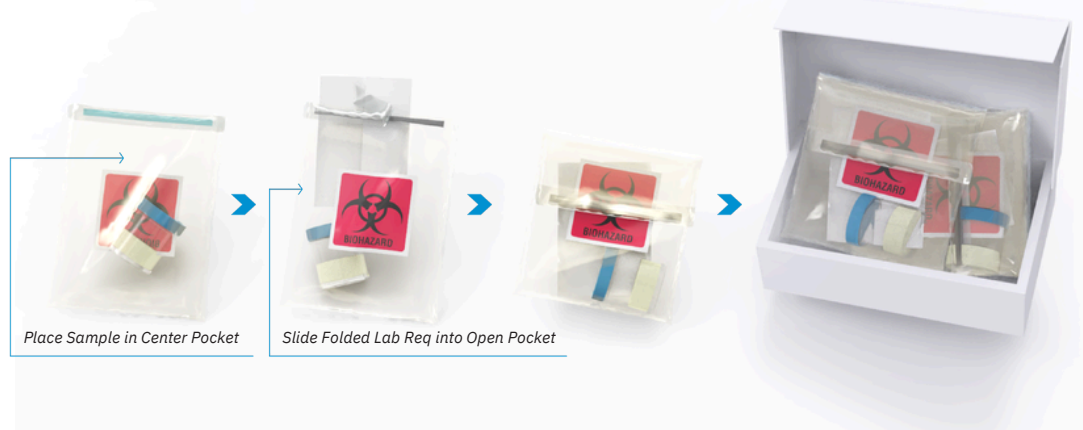

## 3 CONVENIENT FEDEX SHIPPING METHODS

1. Drop into FedEx Dropbox including FedEx locations.
2. For Physician Offices Only: Call for pick up 1-800-GoFedEx (1-800-463-3339). Say "agent" twice to speak to agent. Let them know it's a prepaid pick up.
3. For Physician Offices Only: Use our online "Schedule a Pickup" page at [www.MicroGenDX.com](http://www.MicroGenDX.com). **Make sure to retain your tracking number.**

