

THIS TEST COMES WITH:



COLLECTION DO'S & DON'TS

- ✓ **DO** — Take from the ampule of rectum/distal part of bowel.
- ✓ **DO** — Ship your sample as soon as possible after collection. This is optimal, however, if there is a slight delay, MicroGenDX samples are stable significantly longer than culture samples.
- ✗ **DO NOT** — Use gel or other greasy ointment before insertion of the rectal stick.
- ✗ **DO NOT** — Touch skin around anus in order to prevent any contamination from skin.
- ✗ **DO NOT** — Touch the swab stem.
- ✗ **DO NOT** — Use Biofilm disrupting products. These agents may contain substances, like DNase, that can destroy bacterial DNA and inhibit your results. Consider instructing patients to pause the use of Biofilm disruptors for 24-48hrs prior to sample collection.

RECTAL SWAB METHOD

Particular care should be taken in patients with existing external hemorrhoid nodules that are inflamed to avoid any laceration with subsequent bleeding.

STEP 1

Insertion of the swab has to be gentle with some swirling movement until stick is inside of rectal ampule to at least a depth of 5-6 cm.



STEP 2

The removal of the swab should be performed carefully to avoid any contact with skin around anus. Transfer the swab directly back into the tube that is going to be shipped.



STEP 3

The changing of the swab tip color towards brownish, or the presence of small pieces of feces on tip of swab suggests a quality sample.



SWAB TOILET PAPER METHOD

STEP 1

Wipe with toilet paper to collect fecal matter.

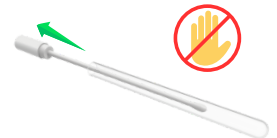

STEP 2

Twist the swab cap at the dotted line to break the seal. Remove the Swab completely from the tube not letting your hands touch the swab beyond the break point.



STEP 3

Roll the swab through the fecal matter collected in the toilet paper.



STEP 4

Insert the swab back into the tube and push to securely close.

SEE PATIENT INFORMATION & SHIPPING INSTRUCTIONS ON REVERSE



Correct packaging is vital to ensuring your sample is processed in a timely manner. Please follow the steps below.

PATIENT INFORMATION

1. MARK SAMPLE

Use a permanent marker to write patient name, date of birth and sample collection date on Multi-Purpose Swab Tube.



2. SIGN LAB REQ

Please have the patient sign the lab requisition form accepting financial responsibility. Be sure the physician has also signed the lab requisition form confirming consent.



3. INSURANCE INFORMATION

Submit patient face sheet and demographics with insurance information or both sides of a patient's insurance card. If this is a prepaid test skip this step.



PACKING SAMPLES FOR SHIPMENT

1. Slide the folded Lab Requisition Form into the open back pocket of the Biohazard Bag.
2. Place the Multi-Purpose Swab into the center sealable pocket of Biohazard Bag.
3. **IMPORTANT:** Place only one Sample and one lab requisition in each Biohazard Bag.
4. Securely seal the Biohazard Bag making sure it is completely closed.
5. Place the sealed Biohazard Bag into the MicroGenDX Shipping Box (**shipping label already attached to bottom of box*).
6. Close the MicroGenDX Shipping Box and seal with the clear sealing sticker or a piece of tape.
7. **You can add multiple completed Biohazard Bags into the MicroGenDX Shipping Box.**

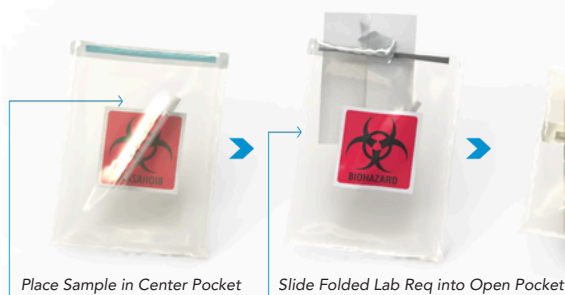

Place Sample in Center Pocket

Slide Folded Lab Req into Open Pocket



3 CONVENIENT FEDEX SHIPPING METHODS

1. Drop into FedEx Dropbox including FedEx locations.
2. For Physician Offices Only: Call for pick up 1-800-GoFedEx (1-800-463-3339). Say "agent" twice to speak to agent. Let them know it's a prepaid pick up.
3. For Physician Offices Only: Use our online "Schedule a Pickup" page at www.MicroGenDX.com. **Make sure to retain your tracking number.**

