

### THIS TEST COMES WITH:



Multi-Purpose Swab



Biohazard Bag



Lab Requisition



Shipping Box  
(with Return Label)

### COLLECTION DO'S & DON'TS

- ✓ **DO** — Take from the ampule of rectum/distal part of bowel.
- ✓ **DO** — Ship your sample as soon as possible after collection. the provided steps carefully. This is optimal, however, if there is a slight delay, MicroGenDX samples are stable significantly longer than culture samples.
- ✗ **DO NOT** — Use gel or other greasy ointment before insertion of the rectal stick.
- ✗ **DO NOT** — Touch skin around anus in order to prevent any contamination from skin.
- ✗ **DO NOT** — Touch the swab stem.

### RECTAL SWAB METHOD

*Particular care should be taken in patients with existing external hemorrhoid nodules that are inflamed to avoid any laceration with subsequent bleeding.*

#### STEP 1

Insertion of the stick has to be gentle with some swirling movement until stick is inside of rectal ampule to at least a depth of 5-6 cm.



#### STEP 2

The removal of the stick should be performed carefully to avoid any contact with skin around anus. Transfer the stick with swab head directly inside of tube that is going to be shipped.



#### STEP 3

The change of stick tip color towards brownish, or the presence of small pieces of feces on tip of stick suggests a quality sample.



### SWAB TOILET PAPER METHOD

#### STEP 1

Wipe with toilet paper to collect fecal matter.



#### STEP 2

Twist the swab cap at the dotted line to break the seal. Remove the Swab completely from the tube not letting your hands touch the swab beyond the break point.



#### STEP 3

Roll the swab through the fecal matter collected in the toilet paper.



#### STEP 4

Insert the swab back into the tube and push to securely close.



SEE PATIENT INFORMATION &  
SHIPPING INSTRUCTIONS ON REVERSE



Correct packaging is vital to ensuring your sample is processed in a timely manner. Please follow the steps below.

## PATIENT INFORMATION

### 1. MARK SAMPLE

Use a permanent marker to write patient name, date of birth and sample collection date on Multi-Purpose Swab Specimen Tube.



### 2. SIGN LAB REQ

Please have the patient sign the lab requisition form accepting financial responsibility. Be sure the physician has also signed the lab requisition form confirming consent.



### 3. INSURANCE INFORMATION

Submit patient face sheet and demographics with insurance information or both sides of a patient's insurance card. If this is a prepaid test skip this step.



## PACKING SAMPLES FOR SHIPMENT

1. Place the Multi-Purpose Swab into the center/sealable pocket of Biohazard Lab Bag.
2. Place folded Lab Requisition Form into the short pocket of the Lab Bag.
3. **IMPORTANT:** Place only one Sample and one Lab Requisition in each Lab Bag.
4. Peel strip off Lab Bag to expose adhesive backing and follow instructions printed on Bag to create a continuous, airtight seal.
5. Place the sealed Lab Bag into the MicroGenDX Shipping Box (shipping label already attached to bottom of box).
6. Close the MicroGenDX Shipping Box and seal with the clear sealing sticker or a piece of tape.
7. You can add multiple completed lab bags into the MicroGenDX Shipping Box.

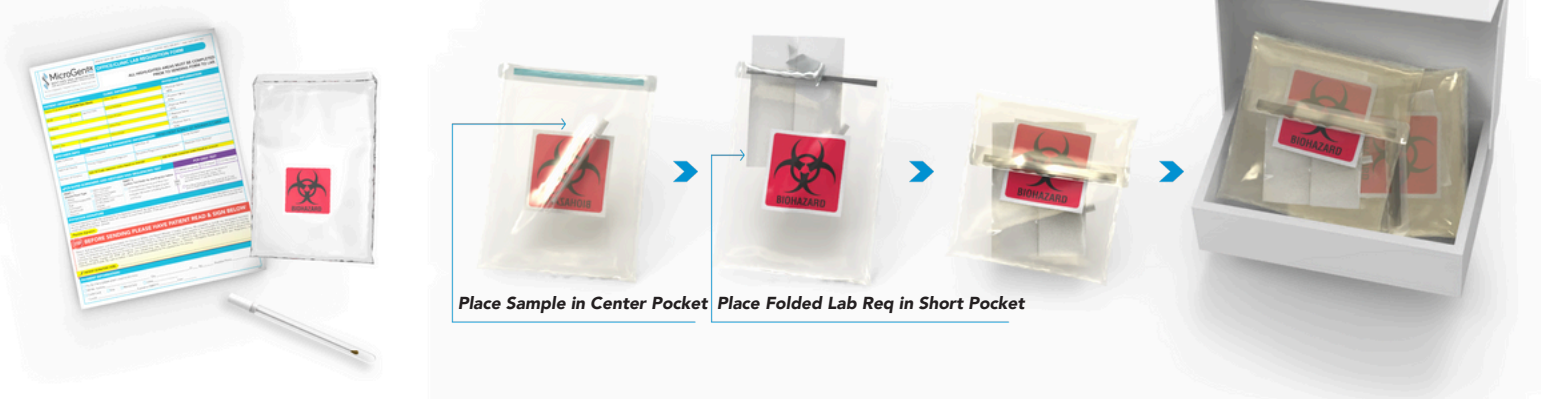

## 3 CONVENIENT FEDEX SHIPPING METHODS

1. Drop into FedEx Dropbox including Kinkos FedEx locations
2. For Physician Offices Only: Call for pick up 1-800-GoFedEx (1-800-463-3339). Say "agent" twice to speak to agent. Let them know it's prepaid pick up.
3. For Physician Offices Only: Use our online "schedule a pick up" page at [MicroGenDX.com](http://MicroGenDX.com). Make sure to retain your tracking number.

