

THIS TEST COMES WITH:



1 GI Collection Tube
Cary Blair w/Indicator



1 Bio Bag



1 Lab Requisition



Box with
Return Label

COLLECTION DO'S & DON'TS

- ✓ **DO** - Collect sample in clean container.
- ✓ **DO** - Wash hands well.
- ✓ **DO** - Ship the sample as soon as possible after collection. MicroGenDX stability testing shows samples as viable at room temperature for at least 21 days after collection.
- ✗ **DO NOT** - Allow sample to touch toilet water or urine.
- ✗ **DO NOT** - Take antibiotics. Patient should be off all antibiotics for 2 days prior to collection. This is optimal. However, if not possible, the test can still be run.

STOOL COLLECTION METHOD

STEP 1

Cover the toilet bowl with plastic wrap. To use plastic wrap, lift up the toilet seat and then place the plastic wrap across the toilet bowl. Close the toilet seat on the plastic wrap to help secure it.

You can also tape the plastic wrap to the side of the bowl for additional security.

Before you defecate, push down on the plastic to create a small dip in the plastic where the sample will collect.



STEP 2

Carefully open the green-capped container. Using the spoon-like scoop, add fecal matter into the container until the liquid reaches the **ARROW** marked on the label. **IMPORTANT:** Try to take some stool from areas that appear bloody, slimy or watery. If stool is hard, take sample from each end and from the middle.

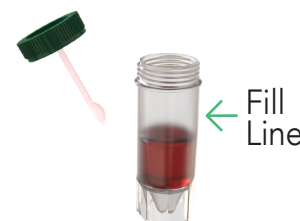

STEP 3

Mix the contents of the vial with the collection spoon. Insert the cap back onto the container and screw the lid on tightly. Shake the tube vigorously to mix sample with liquid.



STEP 4

Wash Hands Thoroughly.



Scan this code to view video sample collection instructions.

SEE PATIENT INFORMATION & SHIPPING INSTRUCTIONS ON REVERSE



Correct packaging is vital to ensuring your sample is processed in a timely manner. Please follow the steps below.

PATIENT INFORMATION

1. MARK SAMPLE

Use a permanent marker to write patient name, date of birth and sample collection date on Collection Container.



2. SIGN LAB REQ

Please have the patient sign the lab requisition form accepting financial responsibility. Be sure the physician has also signed the lab requisition form confirming consent.



3. INSURANCE INFORMATION

Submit patient face sheet and demographics with insurance information or both sides of a patient's insurance card. If this is a prepaid test skip this step.



PACKING SAMPLES FOR SHIPMENT

1. Place the Collection Container into the center/sealable pocket of Biohazard Lab Bag.
2. Place folded Lab Requisition Form into the short pocket of the Lab Bag.
3. **IMPORTANT:** Place only one Sample and one Lab Requisition in each Lab Bag.
4. Peel strip off Lab Bag to expose adhesive backing and follow instructions printed on Bag to create a continuous, airtight seal.
5. Place the sealed Lab Bag into the MicroGenDX Shipping Box (shipping label already attached to bottom of box).
6. Close the MicroGenDX Shipping Box and seal with the clear sealing sticker or a piece of tape.
7. You can add multiple completed lab bags into the MicroGenDX Shipping Box.

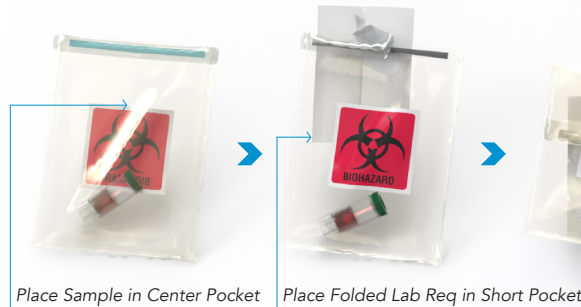

3 CONVENIENT FEDEX SHIPPING METHODS

1. Drop into FedEx Dropbox including Kinkos FedEx locations
2. For Physician Offices Only: Call for pick up 1-800-GoFedEx (1-800-463-3339). Say "agent" twice to speak to agent. Let them know it's prepaid pick up.
3. For Physician Offices Only: Use our online "schedule a pick up" page at MicroGenDX.com. *Make sure to retain your tracking number.*

